

永磁直流伺服电动机规格书

PERMANENT MAGNET DC SERVO MOTOR SPECIFICATION

版本 REV	变更号 ECN NO	变更内容 CONTENT CHANGED	处数 NO.	日期 DATE	设计 DESIGN

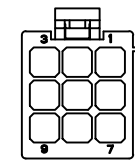
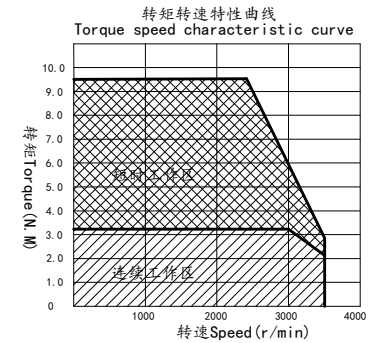
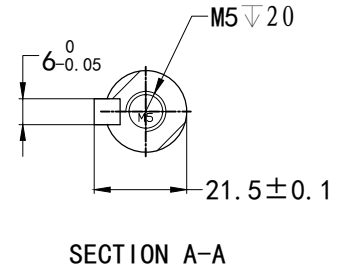
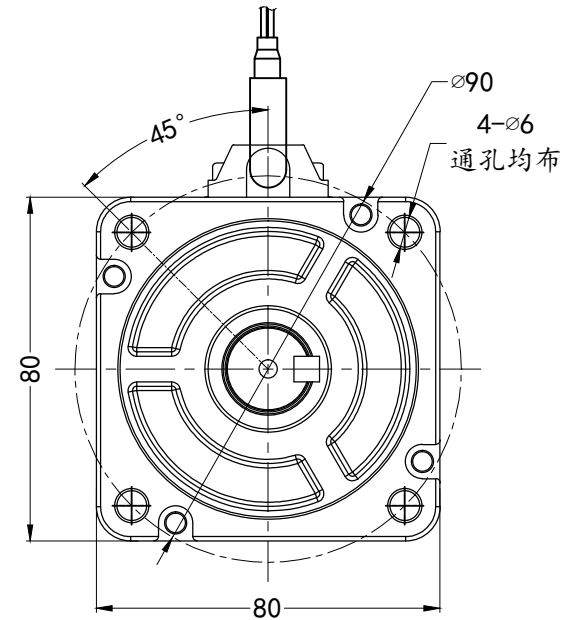
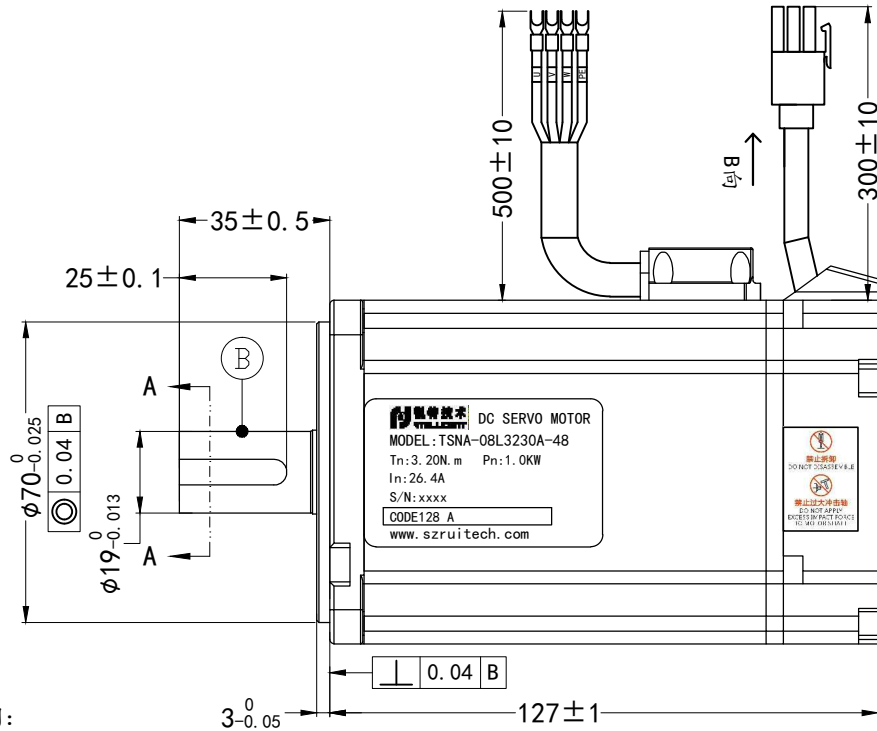

B向视图

塑壳: AMP172169-1
端子: 170359-1

使用说明:

Instructions

使用环境温度-20--40° C不结冰
Operating ambient temperature -20--40 ° C no ice
使用环境湿度20%--80%RH不结露
Operating environment humidity 20%--80%rh no condensation

1000m以下使用, 1000m以上请降额使用, 具体参照海拔降额曲线

For use below 1000m, please reduce the rating for use above 1000m. Refer to the altitude derating curve for details

电源线端子拉脱力 < 400N
Pull off force of power line terminal is less than or equal to 400N

编码器线端子拉脱力 < 13N
Pull off force of encoder line terminal is less than or equal to 13N

参数列表

parameters List

额定电压 Rated Voltage (V)	48	线电阻 Line-Line Resistance (Ω)	0.047±10% (20°C)	23位多圈光电接线顺序 23-bit multi-turn photoelectric encoder wiring sequence								电机绕组接线顺序 Motor winding wiring sequence							
额定功率 Rated Power (W)	1000	线电感 Line-Line Inductance (mH)	0.2±20% (20°C)	序号 Serial number	1	2	3	4	5	6	7	序号 Serial number							
额定电流 Rated Current (A)	26.4	转动惯量 Rotor inertia (×10 ⁻⁴ kg/m ²)	2.11	颜色 Color	屏蔽	红 Red	白 White	黄 Yellow	绿 Green	蓝 Blue	黑 Black	颜色 Color	红 Red	白 White	黑 Black	黄绿 Yellow/Green			
峰值电流 Peak Current (A)	73.2	绝缘等级 Insulation Class	F	定义 Definition	PE	VCC	GND	SD+	SD-	BAT+	BAT-	定义 Definition	U	V	W	PE			
额定转速 Rated Speed (rpm)	3000	绝缘电阻 Insulation resistance	DC500V ≥10MΩ	CTQ SIGN: Customer Process Law 材料符合ROHS要求 All Material Are To Be Rohs Compliant															
最高转速 Peak Speed (rpm)	3500	防护等级 Protection class	IP65 <th colspan="4">NAMES</th> <th colspan="4">SIGNATURE</th> <th colspan="4">DATE</th> <th colspan="4">Unspecified tolerance</th>	NAMES				SIGNATURE				DATE				Unspecified tolerance			
额定转矩 Rated Torque (N.M)	3.20	允许最大径向负载 Maximum allowable radial load (N)	390	设计 DESIGN				陈昊				2022 7.4				常规公差: Tolerances 角度 Angles ±0.1° 倒角 Chamfer ±0.3			
峰值转矩 Peak Torque (N.M)	9.60	允许最大轴向负载 Maximum allowable axial load (N)	140	标准化 STANDARD												Unit: mm GB/T1804-M ISO2768-1 ClassM			
反电势 Voltage Constant (V/Krpm)	8	重量 Weight (kg)	2.95	审核 CHECK				刘星								视角 FIRST ANGLE METHOD			
力矩系数 Torque Coefficient (N.M/A)	0.12															比例 SCALE			
																单位 UNIT			
																变更标识 ECN SIGN			
																名称 TITLE			
																图号 DWG. NO			
																表单编号 Form Code			
																TSNA-08L3230A-48			
																/			
																1			
																版本 REV			
																A			
																深圳锐特机电技术有限公司 Shenzhen Rtelligent Technology Co.,Ltd			